



Loft 400 Beverage Center

INSTRUCTION MANUAL

PLEASE READ THIS MANUAL CAREFULLY BEFORE INSTALLING AND OPERATING.

TABLE OF CONTENTS

Contents	Page #
Diagram & Description of Beverage Center	3
Important Safety & Pre-Use Instructions	4
Installation Instructions	
(a)General Installation Instructions	4
(b)Installation of Unit as a Built-In Appliance	5
(c)Reversing Door Swing	5
Operating Your Beverage Center	7
Door Lock	8
Layout & Storage	9
Removing the Rolling Shelf	9
Care & Maintenance	9
Troubleshooting Guide	10
Technical Data	11
Warranty Information	12

DIAGRAM & DESCRIPTION OF BEVERAGE CENTER

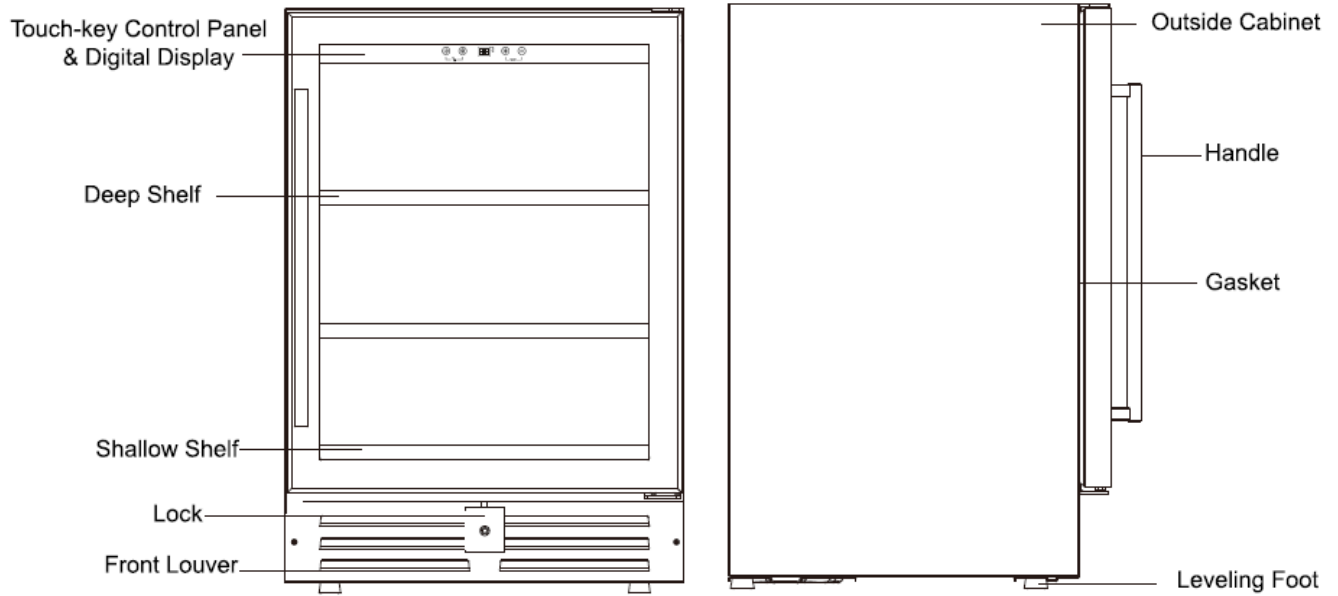

YOUR BEVERAGE CENTER ALSO INCLUDES THE FOLLOWING:

- Instruction manual
- 1 Rolling Wine Shelf, 2 Beverage Shelves (1 Shallow and 1 Deep)
- 2 keys
- 1 handle

IMPORTANT SAFETY & PRE-USE INSTRUCTIONS

WARNING	To reduce the risk of fire, electrical shock, or injury when using your appliance, follow these basic precautions:
<ul style="list-style-type: none">● Read all instructions before using the beverage center.● DANGER: Risk of child becoming trapped in new cellar, old beverage center/refrigeration unit, or large boxes. Junked or abandoned appliances, boxes and other containers are still dangerous, even if they will “just sit in the garage for a few days”.● Before you throw away your old beverage center or refrigeration unit: 1. Take off the door. 2. Leave the shelves in place so that children cannot climb inside.● Never allow children to operate, play with, or crawl inside the appliance.● Never clean appliance parts with flammable fluids. The fumes can create a fire hazard or explosion.● Do not store in the vicinity of any other appliance. Do not store near gasoline or any other flammable vapors. The fumes can create a fire hazard or explosion. <p style="text-align: center;">-Save these instructions-</p>	

BEFORE USING YOUR BEVERAGE CENTER

- Remove the exterior and interior packaging.
- Before connecting the beverage center to the power source, let it stand upright for approximately **24** hours. This will reduce the possibility of a malfunction in the cooling system from handling during transportation.
- Clean the interior surface with lukewarm water using a soft cloth.

INSTALLATION INSTRUCTIONS

(a) General Installation Instructions

- This appliance is designed for free standing installation or can be recessed into cabinetry.
- Place your beverage center on a flat, solid floor that is strong enough to support it when it is fully loaded. To level your beverage center, adjust the front leveling leg at the bottom of the beverage center.
- When moving your beverage center, please do not incline it more than 45 degrees.
- Locate the beverage center away from direct sunlight and sources of heat (stove, heater, radiator, etc.). Direct sunlight may affect the acrylic coating and heat sources may increase electrical consumption. Extreme cold ambient temperatures may also cause the unit to perform improperly.
- Avoid locating the unit in damp areas.
- Plug the beverage center into a dedicated (for this appliance only), properly installed and grounded wall outlet. Do not under any circumstances cut or remove the third (grounding) prong from the power cord. Any questions concerning power and/or electrical grounding should be directed to a certified electrician or authorized product service center.

(b) Installation of Unit as a Built-In Appliance

The cutout dimensions illustrated below allows for door clearance and access to the pull-out shelves when installed as a built-in appliance.

Your beverage center has been manufactured with a zero clearance door so no extra space is required to account for the door swing when building into cabinetry.

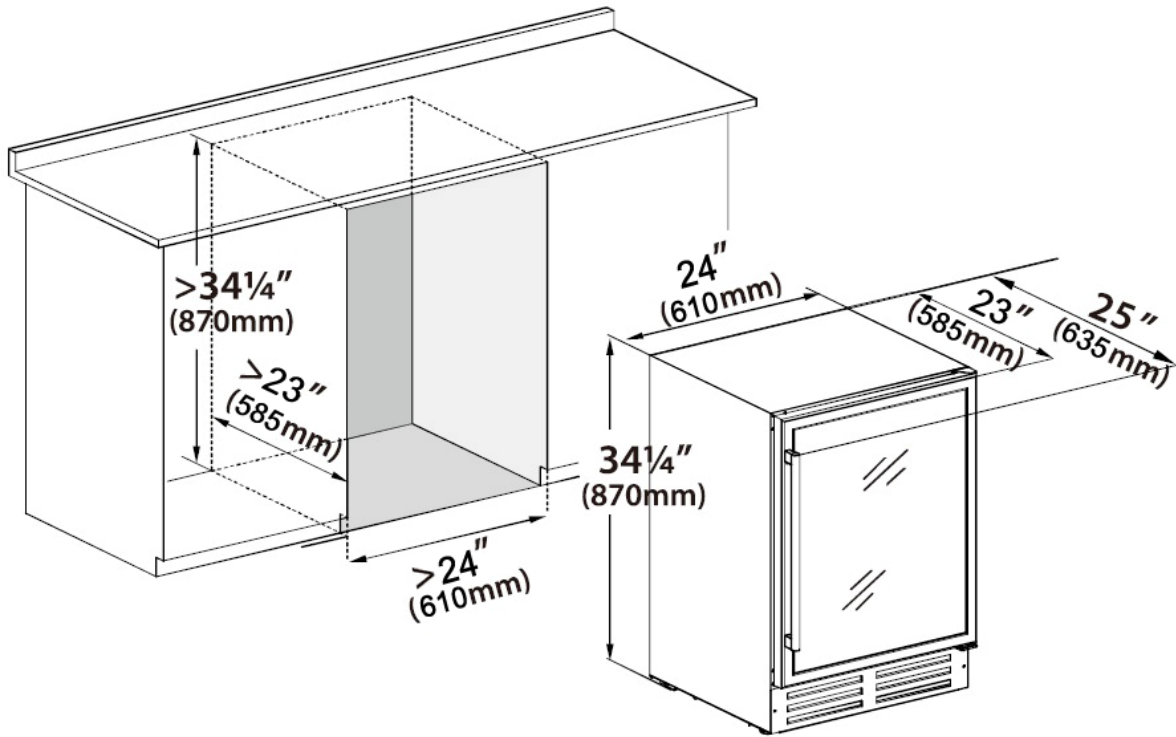

These cut out dimensions show the minimum space required for your beverage center to perform as designed.

The power cord is located at the right rear corner (when facing the front of the unit) of the beverage center. The power cord length is 70"

Use only a 15-amp dedicated outlet with this beverage center.

Note: If your cabinets are less than 34 1/4" in height, you can remove the leveling legs on the bottom of the beverage center to reduce its height by 1/2". You must use shims to level the beverage center if you remove the leveling legs.

(c) Reversing the Door Swing of Your Appliance

Before you begin: Tape down shelves to avoid movement during the process

- The unit may have been delivered to you with the door opening from the left side (hinges on the right).
- The door of this appliance can be hung to open on the left or right side. To reverse the door swing of your cellar and open from the opposite side, please follow the instructions and diagram below.

1. Open the door, and loosen the screws from the support rod of the bottom hinge.

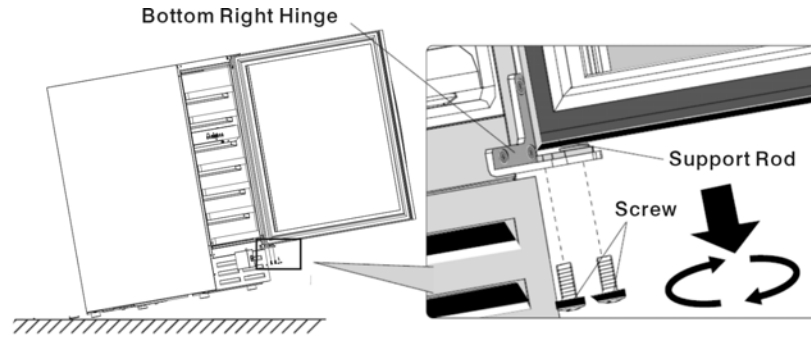

2. Remove the door off the upper hinge and take out the support rod.

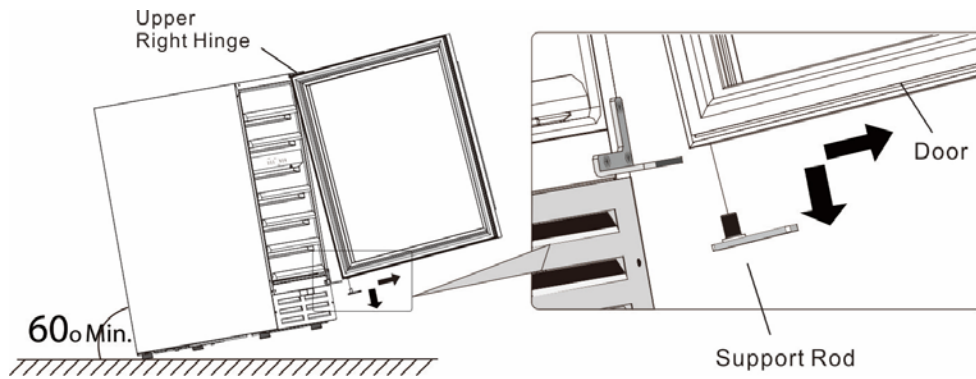

3. Use a small flat head screwdriver to pry up the lock hole cap on the top of the door and remove to the bottom.

4. Unscrew the upper hinge and bottom hinge.

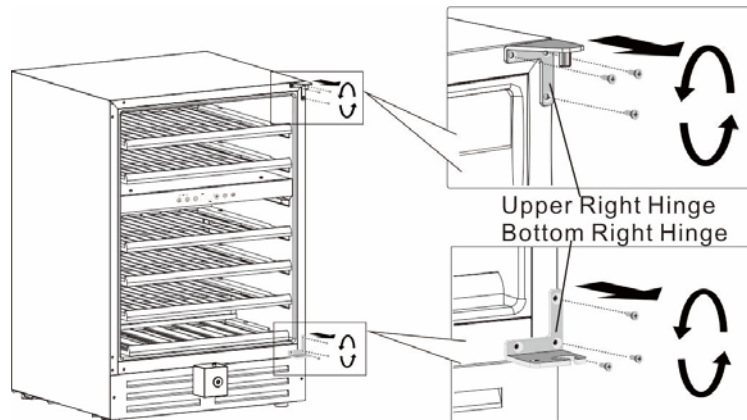

5. Pry out the plastic caps at the left side of the cabinet, and remove them to the right side.

6. Install the hinge set which are packed as accessories with the instruction manual to the opposite side.

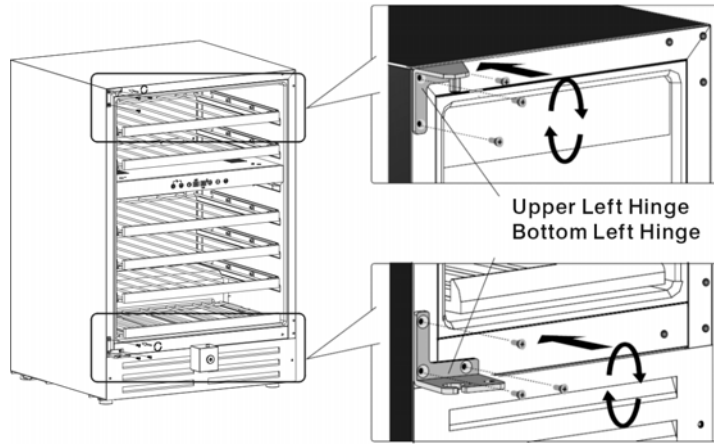

7. Rotate the door 180° so that the top is now the bottom, and install it by attaching the support rod with screws.

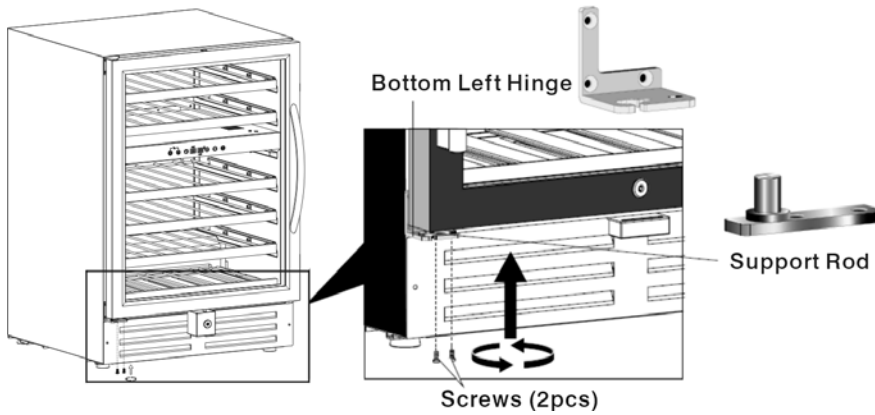

Stainless steel doors include a handle centered in the middle of the door. There is no need to alter the location of the handle.

Glass doors include integrated door pull handles. There is no need to alter the location of door pull handles.

OPERATING YOUR BEVERAGE CENTER

Each beverage center includes an operating panel on the front of the unit. This operating panel includes several features to operate and control the temperature the beverage center. The operating panel includes the following features:

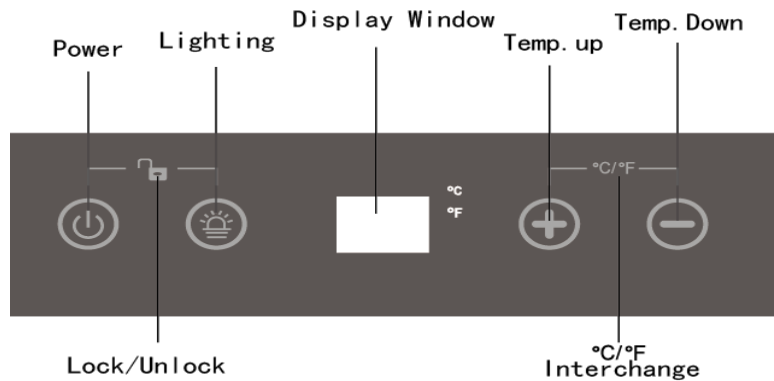

Power:	Turns the beverage center system on or off.
Lighting:	Turns the interior beverage center light on or off.
Power/Lighting:	Lock/Unlock button.
°C/°F:	Alters the temperature display to Fahrenheit or Celsius
Display Window:	Displays temperature
Temp.Up:	Increases temperature
Temp.Down:	Decreases temperature

BEFORE YOU START: The beverage center should be placed in a location where the ambient temperature is between 60-80°Fahrenheit. If the ambient temperature is outside this range, the performance of the unit may be affected. For example, placing your unit in extreme cold or hot conditions may cause interior temperatures to fluctuate.

Lock/Unlock

Your beverage center includes a feature that will lock the control panel when if left untouched for 10 seconds. To unlock the beverage center control panel touch the power and lighting buttons simultaneously for 3 seconds.

Setting Temperature

- 1 Make sure power cord is connected to a properly grounded outlet.
- 2 Turn power ON.
- 3 The temperature setting can be adjusted from 36°F to 68°F
- 4 Temperatures increase or decrease 1°F with each push of the UP (+) or DOWN (-) button.

NOTE:

Temperatures may fluctuate depending on whether the interior light is ON or OFF and depending on the position of the bottles.

NOTE:

- In the event of a power interruption, your beverage center will revert back to the factory settings, 36° F in the cabinet, once power is restored.
- If the unit is unplugged, loses power, or is turned off, you must **wait 3 to 5 minutes before restarting.** Attempting to restart the beverage center before this time has elapsed may prevent the beverage center from starting.
- **When you use the beverage center for the first time or restart the beverage center after having been shut off for a long time, there will be a few degrees variance between the temperature you select and the one indicated on the LED readout for the first few hours of operation. After a few hours of operation, the temperature will normalize to the displayed temperature.**

DOOR LOCK

- This unit comes with a key lock.
- The keys are located inside the plastic bag that contains the instruction manual. To unlock the door, insert the key into the lock and turn counterclockwise.
- To lock the door, simply reverse the operation making sure the metal pin is engaged completely. Then remove the key and place it in a secure place for safekeeping.

LAYOUT AND STORAGE

Your cabinet was designed to store a maximum number of beverage securely. We recommend that you observe the tips below to optimize loading.

- Remove tape from shelves once unit is stable and ready for storage.
- Disperse the bottles evenly to avoid concentrating weight in one place. Bottles must not touch either the back of the cabinet or the step at the bottom. Make sure that the bottles are not all grouped together either at the top or bottom of the cabinet. Bottles dispersed evenly throughout the cabinet will contribute to optimal cooling.
- Only pull out one rolling shelf at a time. Never attempt to pull more than one.
- Maximum weight capacity per shelf is 55 lbs.

REMOVING THE ROLLING SHELF

To remove the rolling wine shelf:

1. Remove all bottles.
2. Pull out the shelf to align the shelf grooves to the stoppers fixed on the inside cabinet.
3. Push upward the shelf from the telescopic rails and remove it carefully.

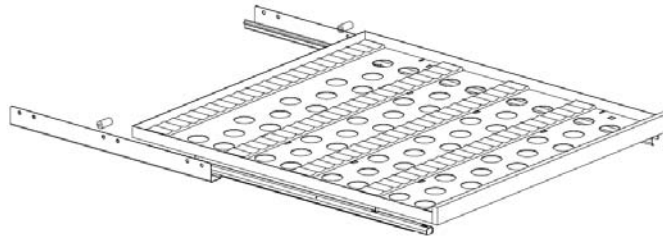

CARE AND MAINTENANCE

Cleaning Your Beverage Center

- Turn off the power, unplug the appliance, and remove all items including all shelves.
- Wash the inside surfaces with a solution of warm water and baking soda (approximately 2 tablespoons of baking soda for each quart of water.)
- Wash the shelves with a mild detergent solution.
- Wring excess water out of the sponge or cloth when cleaning area of the controls, or any electrical parts.
- Wash the exterior with warm water and mild liquid detergent. Rinse well and wipe dry with a clean soft cloth.
- Vacuum the front grill and back of the unit twice yearly. Make sure the power is off before cleaning.
- It is recommended to clean the unit completely inside and out once a year to maximize the longevity of the beverage center.

Power Loss

- Power failures that are corrected within a few hours should not affect the temperature of your appliance if you minimize the number of times the door is opened. If the power is going to be off for a longer period of time, you need to take other measures to protect your contents.
- If the unit is unplugged, loses power, or is turned off, you must **wait 3 to 5 minutes before restarting**. Attempting to restart the beverage center before this time has elapsed may prevent the beverage center from starting.

Absence/ Vacation

- **Short vacations:** You may leave the beverage center powered on and unattended for absences of less than three (3) weeks.
- **Long vacations:** If the appliance will not be used for more than three weeks, remove all items and turn off the appliance. Clean and dry the interior thoroughly. To prevent mold growth, leave the door open slightly, blocking it open if necessary.

Moving Your Beverage Center

- Remove all items.
- Securely tape down all loose items (shelves) inside your appliance.
- Turn the adjustable leg up to the base to avoid damage.
- Tape the door shut.
- Be sure the appliance stays secure in the upright position during transportation. Also protect the outside of the appliance with a blanket or similar item.

Energy Saving Tip

- The beverage center should be located in the coolest area of the room, away from heat producing appliances, and away from direct sunlight.

TROUBLESHOOTING GUIDE

Many common issues with your beverage center can be solved very easily. Try the troubleshooting tips below should you experience any problems

PROBLEM	POSSIBLE CAUSE
Beverage center does not operate.	Not plugged in. The appliance is turned off. The circuit breaker tripped or a fuse has blown out.
Beverage center is not cold enough.	Confirm the temperature setting is correct The external environment may be too warm, and therefore the beverage center requires a higher setting. The door is opened too often. The door is not closed completely. The door gasket is not sealing properly.
Beverage center is turning on and off frequently.	The room temperature is hotter than normal. The door is opened too often. The door is not closed completely. The temperature control is not set correctly. The door gasket does not seal properly.
The light does not work.	Not plugged in. The circuit breaker tripped or a fuse has blown. The light bulb has burned out. The light button is "OFF".
Vibrations.	Check that the beverage center is on a level surface.
The beverage center seems to make too much noise.	A faint humming noise may come from the flow of the refrigerant, which is normal. As each cycle ends, you may hear gurgling sounds caused by the flow of refrigerant in your beverage center. Contraction and expansion of the inside walls may cause popping and crackling noises. The beverage center is not on a level surface.
The door will not close properly.	The beverage center is not on a level surface. The door was reversed and not properly installed. The gasket is dirty. The shelves are out of position.

The area around the door, top, or side is hot.	Your beverage center comes with a heating element near the door that keeps frost and condensation off the cabinet frame and it's normal for this area to feel warm. It will not affect the temperature inside the beverage center.
--	--

TECHNICAL DATA

	Loft Beverage Center
Type of cooling	Compressor & air-circulated fan cooling
Nominal voltage/Frequency	115V/60Hz
Rated power(W)	160W
Ambient temperature	60-80 degrees Fahrenheit
Temperature range	36-68F
Range of inside cabinet humidity	60%RH
Item weight	102 pounds
Item dimension	24"W X 23"D X 34 ¹ / ₄ "H Door handle will add 2" to depth

WARRANTY INFORMATION

For five years from the date of purchase, your Loft 400 Beverage Center warranty covers the internal compressor if it proves to be defective in materials or workmanship. In addition, for one year from the date of original delivery, your Loft 400 Beverage Center warranty covers all parts and labor to repair or replace any components in the beverage cooling unit that prove to be defective in materials or workmanship.

All service provided by IWA under the above warranty must be performed by IWA or a designated repair facility unless otherwise specified by IWA. Purchaser is responsible for shipping the beverage cooling unit to and from IWA or to and from a designated repair facility.

The limited warranty applies only to Loft 400 Beverage Centers purchased from IWA or an authorized dealer. Damage caused by others or by any cause beyond the control of IWA, shall not be considered defects in material or workmanship and are not covered by the warranty. The limited warranty does not cover any parts or labor to correct any defect caused by negligence, commercial use, accident, or improper use, maintenance, installation, service or repair.

THE REMEDIES DESCRIBED ABOVE FOR EACH WARRANTY ARE THE ONLY ONES, WHICH IWA WILL PROVIDE, EITHER UNDER THESE WARRANTIES OR UNDER ANY WARRANTY ARISING BY OPERATION OF LAW. IWA WILL NOT BE RESPONSIBLE FOR ANY CONSEQUENTIAL OR INCIDENTAL DAMAGES ARISING FROM THE BREACH OF THESE WARRANTIES OR ANY OTHER WARRANTIES, WHETHER EXPRESS, IMPLIED OR STATUTORY.

Some states do not allow the exclusion or limitation of incidental or consequential damages, so the above limitation or exclusion may not apply to you. This warranty gives you specific legal rights and you may also have other legal rights, which vary from state to state.

To receive parts and/or service and the name of a IWA designated repair facility nearest you, contact IWA by calling us at 1.800.527.4072 during regular business hours.